



A Group CBS Company

USERS MANUAL

# RSK-CS MODELS

## A Portable Actuator for Remotely Operating Pistol-grip Circuit Breaker Control Switches



# Distance *is* Safety<sup>®</sup>

WHAT STANDS  
BETWEEN YOU  
AND ARC-FLASH  
DANGER?

WE  
DO.

[CBSArcSafe.com](http://CBSArcSafe.com) | Email: [info@CBSArcSafe.com](mailto:info@CBSArcSafe.com) | **877-4-SAFETY** | Fax: 940-382-9435

Rev. July 2019

## User's Manual for the following RSK-CS models:

RSK-CS01, RSK-CS02, RSK-CS03, RSK-CS04, RSK-CS05, RSK-CS06

- 1.0 Arc-blast Hazards
- 2.0 Safety Information
  - 2.1 Finger pinch points
  - 2.2 Strong magnets
- 3.0 Battery Information
  - 3.0 Battery Requirements
  - 3.1 Battery Life
  - 3.2 Battery Replacement
- 4.0 Operation
  - 4.1 Connecting the control cable
  - 4.2 Sequence of operation
  - 4.3 Attaching and removing the actuator
  - 4.4 Indicator lights
- 5.0 Care and Storage
  - 5.1 Cleaning debris from magnets
  - 5.2 Storage
- 6.0 Warranty
- 7.0 Specifications

### 1.0 Arc-blast Hazards

The hazards associated with electrical arc-blasts are well documented. Studies conducted by numerous industries and professional organizations have sought to quantify the intensity of arc-blast, the risks to personnel, and various methodologies for mitigating the risks.

Without doubt, increasing the distance between the arc and a human is the single greatest favorable factor in reducing injuries.

The Chicken Switch® is not a panacea but rather one more tool available for protecting workers while they are performing electrical switching.

Using a Chicken Switch® may not negate the need for additional personal protective measures. The user is ultimately responsible for evaluating each situation to determine if additional protective measures are needed.



### WARNING

**ELECTRICAL SWITCHING  
MAY PRESENT RISK OF  
SERIOUS INJURY OR DEATH.  
THIS DEVICE SHOULD ONLY  
BE USED BY QUALIFIED  
PERSONS AFTER CAREFUL  
ANALYSIS OF THE HAZARDS.**

## 2.0 Safety Information

ALWAYS connect the control cable to the actuator BEFORE installing the Chicken Switch®.



### 2.1 Finger pinch points

NEVER place your fingers below the red gearbox enclosure when the control station is connected to the actuator. The actuator arm/rollers could pinch your hand/fingers against the frame or motor.

Keep fingers clear of the bottom of the actuator when the actuator is near a ferrous surface.

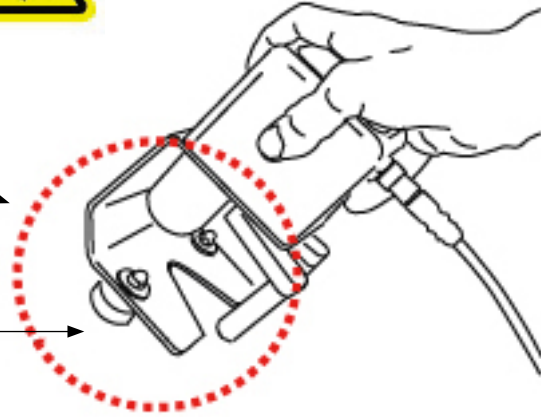

### 2.2 Strong magnets

The holding magnets are very strong. Keep magnetically-sensitive objects such as watches or computer disks away from the bottom of the actuator.

## 3.0 Battery Requirements

- Sixteen (16) AA alkaline cells are required –eight cells in each battery holder. Carefully observe polarity when installing cells.
- Rechargeable NiMh or NiCd can be used.

### 3.1 Battery Life

- A set of fresh alkaline cells should give over 700 operations.

### 3.2 Battery Replacement

- ALWAYS disconnect the control cable before replacing batteries to avoid possible static damage of the electronics!
- Turn the control station upside down, remove the endplate retaining knob. Remove the endplate

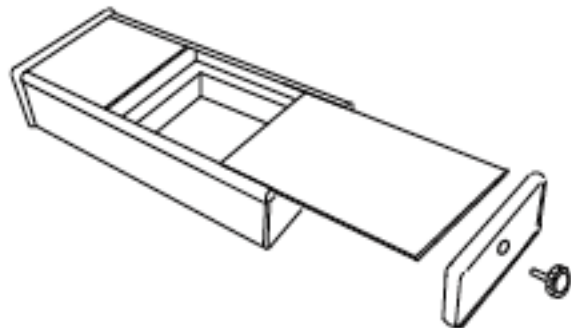

### 3.3 To connect/disconnect batteries

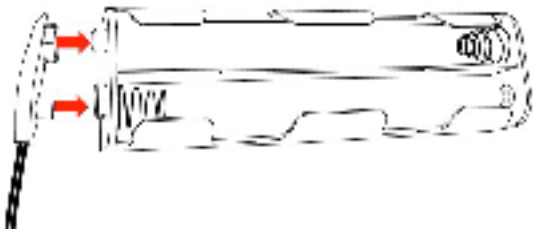

### 3.4 CAUTION: Static Discharge Potential

- To avoid possible damage to electronic components disconnect the control cable before replacing batteries.

## WARNING

**TO AVOID POSSIBLE  
DAMAGE TO ELECTRONIC  
COMPONENTS DISCONNECT  
CONTROL CABLE BEFORE  
REPLACING BATTERIES.**

### 4.0 Operation

ALWAYS connect the control cable to the actuator BEFORE installing the Chicken Switch®.

### 4.1 Connecting the control cable



1. Align the arrow on the cable end with the top of the receptacle.
2. Push in and engage the threads on the coupling nut and turn clockwise.
3. After one or two turns of the coupling nut, push in on the cable end. Repeat this until the connector is fully seated.
4. Use a similar technique of turn-stop-and-pull to disengage the cable ends.

### 4.2 Sequence of Operation:

1. Connect the control cable to the actuator (do not connect the cable to the control station yet).
2. If the actuator arm is not in neutral, it is OK to manually rotate it to neutral.
3. Position the actuator on the circuit breaker control switch that is to be operated. The black rollers on the actuating arm should be on either side of the pistol-grip control switch handle.
4. Plug the control cable into the control station.
5. Ensure you are at a safe distance from the circuit breaker that is to be operated.

### 4.3 Attaching and Removing the Actuator:

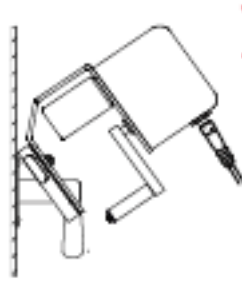

#### To Attach:

Tip the actuator and place the edge of the frame on top of the switch escutcheon plate. Center the actuator with the control switch as much as possible. Rotate the actuator downward, making sure the actuator arm properly engages the control switch handle.

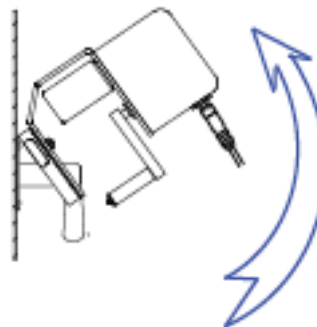
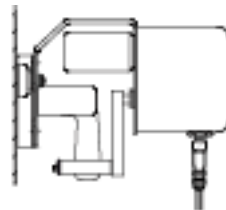

#### To remove:

Grasp the red gearbox cover and rotate the actuator upward. Once the magnets have separated from the switchgear enclosure, lift the actuator clear of the control switch.

*NOTICE: The Chicken Switch® is designed as a portable device. It is not designed to remain with the control unit connected to the actuator for extended periods of time. To do so will deplete a fresh set of batteries in approximately four to five days.*

## 4.4 The indicator lights & controls:

NOTE: the indicator lights only work when the ENABLE button is depressed.

**GREEN:** indicates the actuator is being commanded to rotate in the TRIP direction (CCW).

**RED:** indicates the actuator is being commanded to rotate in the CLOSE direction (CW).

**YELLOW:** indicates the actuator is in the neutral position and the controller and batteries are healthy.

Rapidly **blinking YELLOW** indicates the battery voltage with zero load has fallen to an unacceptable level. Operation is inhibited until batteries with an acceptable voltage level are installed.

### The ENABLE button:

The Enable button must be continuously depressed in order to command the actuator.

Releasing the enable button has the same affect as returning the selector switch to neutral – the actuator moves to neutral.

Note: If the control switch is held in the trip or close position for longer than approximately 3 seconds the drive motor will de-energize and the arm will remain in driven position. When the control switch or the enable button is released, the motor will energize to drive the actuator arm to neutral.

## 4.5 Rotation selector switch (only on select models):

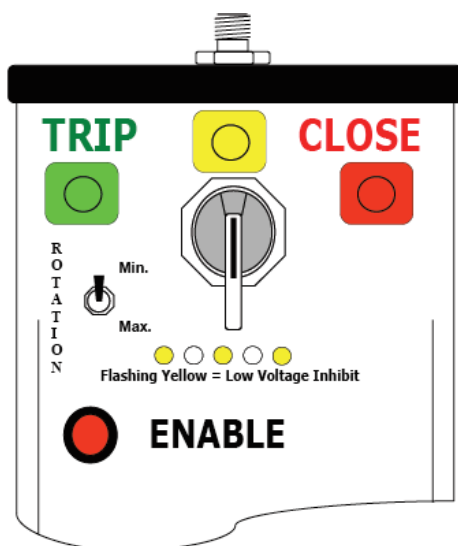

Some Chicken Switch models have a selectable rotation switch.

If equipped, the "Rotation" toggle switch causes the Chicken Switch® to limit its angle of rotation, to accommodate switches that require more or less rotation.

If it is unknown how much rotation a particular switch requires, the user should start with the selector in the 'Min' position. If this amount of movement is inadequate, return the control switch to neutral and move the Rotation toggle switch to 'Max' and try again.

The 'Min' position should be used for control switches that rotate approximately 30 degrees. 'Max' should be used for both, 45 and 90 degree movements.

## 5.1 Cleaning the magnets

Over a period of time, the magnets may attract ferrous debris. Exercise care to avoid setting the actuator where the magnets might attract debris. If this does occur, use a paper towel or nylon bristle brush to clean the face of the magnets. Keeping the magnet faces clean ensures that maximum holding power is maintained.

## 5.2 Storage

Remove all batteries from the control station if the device will not be used for longer than 6 months.

Never store the batteries where the ambient temperature might exceed 110° F.

Avoid getting the unit wet or storing it in a high humidity location.

## 6.0 Warranty

CBS ArcSafe® guarantees all products manufactured by CBS ArcSafe® only against defects in materials and or workmanship for a period of twelve (12) months commencing on the date the product is received by the customer. THIS WARRANTY IS IN LIEU OF ALL OTHER EXPRESS OR IMPLIED WARRANTIES INCLUDING THOSE OF MERCHANTABILITY AND FITNESS FOR A PARTICULAR PURPOSE. CBS ArcSafe® will, at its option and its cost (excluding shipping expenses) repair, replace or refund the purchase price of any product manufactured by CBS ArcSafe® which has a covered defect in materials and/or workmanship. THIS IS CUSTOMER'S EXCLUSIVE REMEDY FOR BREACH OF WARRANTY. IN NO EVENT WILL CBS ARCSAFE'S® LIABILITY FOR DAMAGES (WHETHER ARISING FROM BREACH OF CONTRACT OR WARRANTY, NEGLIGENCE, STRICT LIABILITY OR OTHERWISE) EXCEED THE PURCHASE PRICE OF THE PRODUCT CONCERNED NOR WILL CBS ARCSAFE® BE LIABLE FOR PUNITIVE, INCIDENTAL, CONSEQUENTIAL OR SPECIAL DAMAGES (INCLUDING WITHOUT LIMITATION LOST PROFITS) EVEN IF ADVISED OF THE POSSIBILITY OF SUCH DAMAGES.

This warranty does not cover damage caused by accident, improper care, negligence, normal wear and tear, natural causes, unlicensed repairs, and incompetent supervision. This warranty also does not cover repairs or replacements made by unauthorized individuals except when agreed to in writing. CBS ArcSafe® reserves the right to disallow warranty repairs if the unit has been disassembled or misused, as determined by CBS ArcSafe® in good faith. Please contact us at (877) 472-3389.

## 7.0 Specifications

### MECHANICAL

Holding magnets	Two magnets, each rated @ 55.1 lbs force, 12,600 Gauss.
Gearmotor	All metal gears, in a formed metallic housing. DC brushed, permanent magnet motor with .375 inch diameter shaft (9.5 mm).
Torque	Approximately 70 inch-pounds (7.9 N-m)
Typical operating speed	290 milliseconds (average rotation time) to close the contacts on a pistol-grip switch with 45 degrees of handle rotation.
Projected life	20,000 operations

### ELECTRICAL

Operating voltage	24 volts DC
Fuse	5 amp, quick-blow, AGC-5
Power supply	16 AA alkaline disposable batteries When used properly, one set of batteries should yield over 700 operations.
Control cable	30 feet in length (9.1 meters), 5-conductor, extra-flexible, PUR insulation
Controller	Requires two-hand operation. The 'enable' button must be depressed while rotating the controller selector switch. A separate toggle switch allows the user to select between two levels of rotation (of the actuator).  A programmable micro-controller manages control inputs, motor functions, monitors and limits mechanical travel and performs timing functions to protect the motor in a stalled condition.  An intelligent 'H-bridge' motor driver provides start/stop/braking motor functions. The H-bridge has integral thermal shutdown protection.

### Worldwide Headquarters & U.S. Sales

CBS ArcSafe, Inc. A Group CBS Company  
2616 Sirius Road | Denton, TX 76208  
Ph: 877-4-SAFETY | Ph: 940-382-4411 | Fx: 940-382-9435  
[info@CBSArcSafe.com](mailto:info@CBSArcSafe.com)

### Charleston, WV Facility

4782 Chimney Drive | Charleston, WV 25302  
Ph: 800-248-4958 | Ph: 304-965-9220 | Fx: 304-965-9221

### U.K. /Europe Office

27 Cressey Avenue | Shenley Brook End  
Milton Keynes, Buckinghamshire  
United Kingdom MK57EL  
Phone: +447 770 500577